

CSA A - 11/11/27

1/25/28

1/25/28

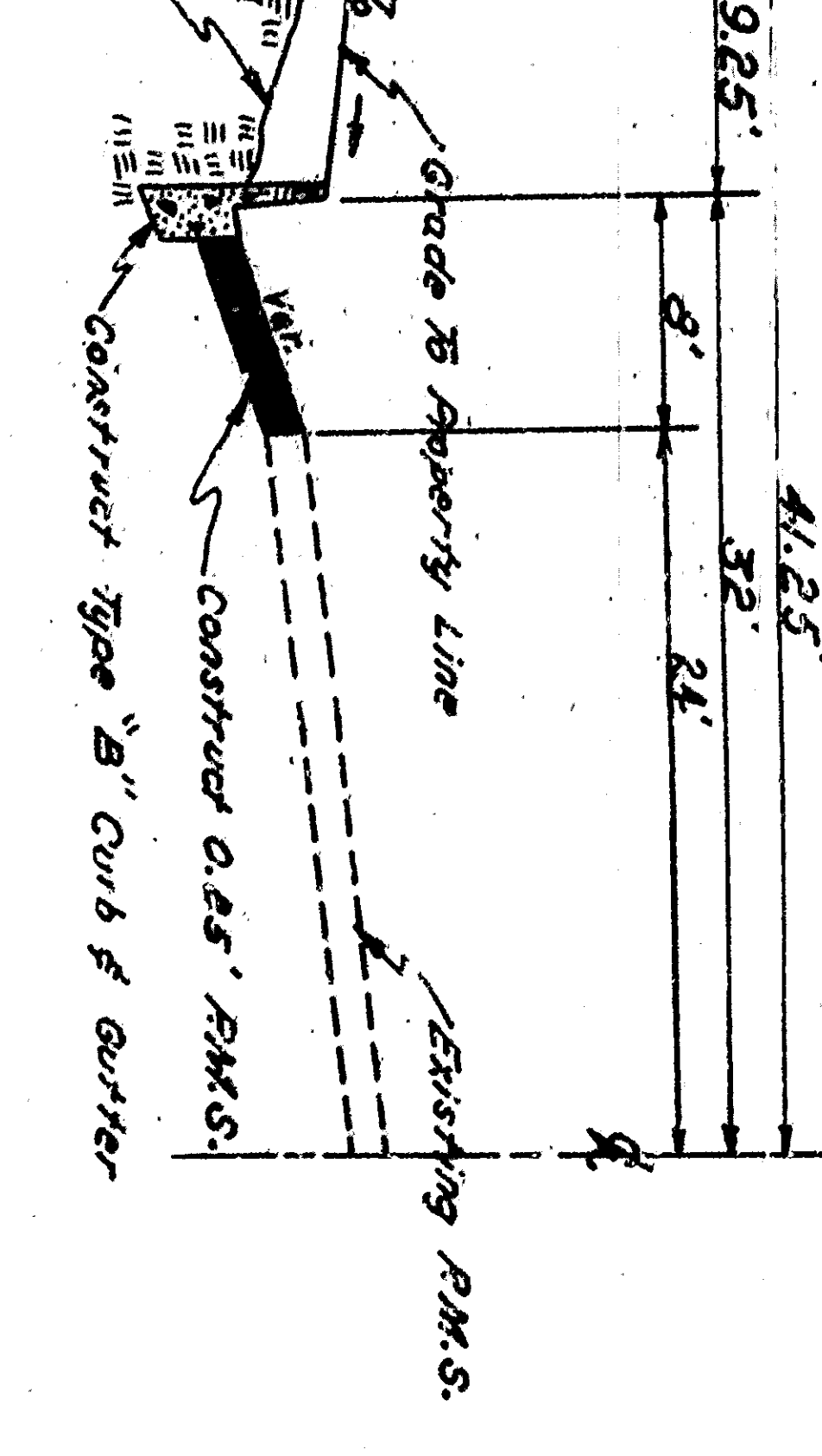
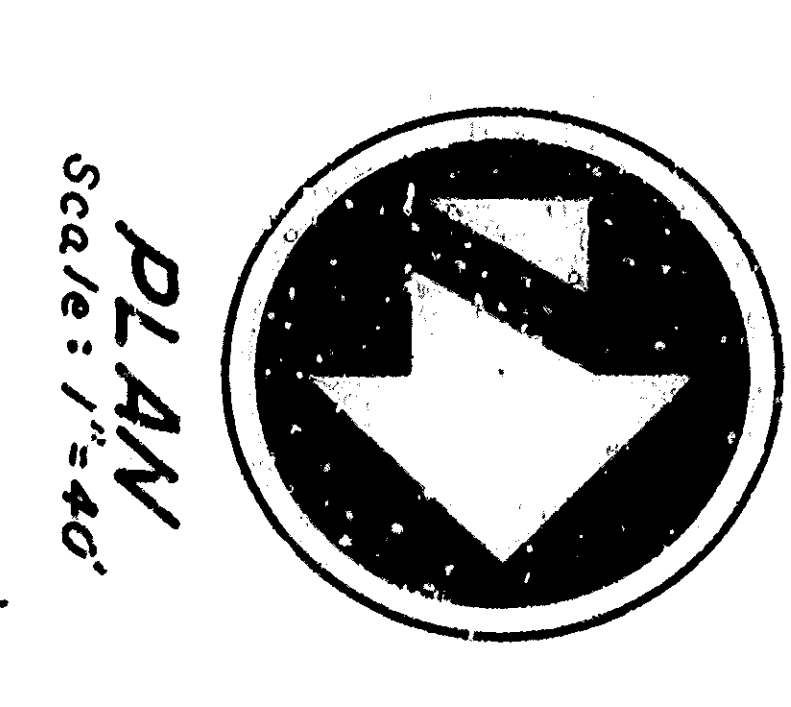
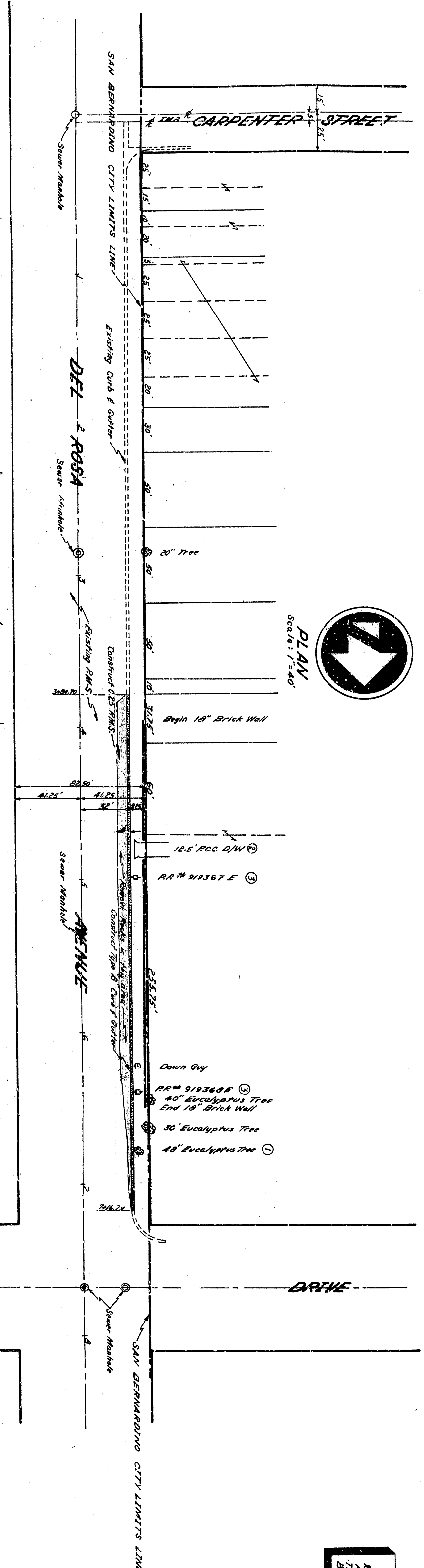


TYPICAL X-SECTION
Scale: 1/4" = 1'-0"

BEVING, JAMES P. 241
 4 LYNWOOD DRIVE & DEL ROSA AVENUE, THIRDS 53 FT NORTH, PLUMB & LEVEL, 250.53 M.S.L.

APPROVED	DATE: 1/25/28	DEPARTMENT OF ENGINEERING
CITY ENGINEER		CITY OF SAN BERNARDINO
REGISTERED CIVIL ENGINEER NO. 1352		CURB, GUTTER & PAVING
DRAWN BY: HARRIS		DEL ROSA AVENUE
2820	CHECKED BY: DEAN	CARPENTER STREET TO LYNWOOD DRIVE
SHEET 7 OF 9	RECOMMENDED	